



## Wim Bronsvoort

- active in solid modeling since 1981
- mainly as associate professor at Delft University of Technology
- co-founder of Solid Modeling Association in 2000 and member of Executive Committee 2001-2005
- paper co-chair SMA conferences 1997, 1999 and 2009



# Contributions

- direct display algorithms of solid models

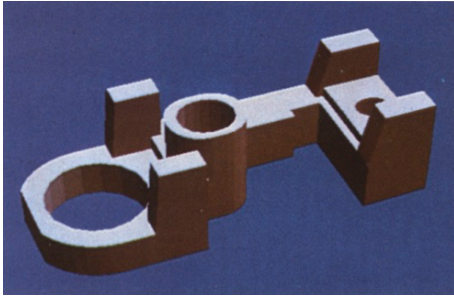

CSG models

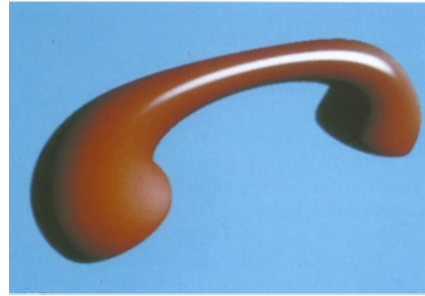

generalized cylinders

- multiple-view,  
semantic,  
assembly,  
freeform and  
collaborative

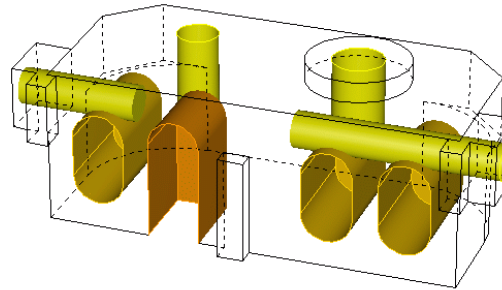

**feature modeling**

# Major contributions

- **multiple-view feature modeling:** each application can have its own view on a product model

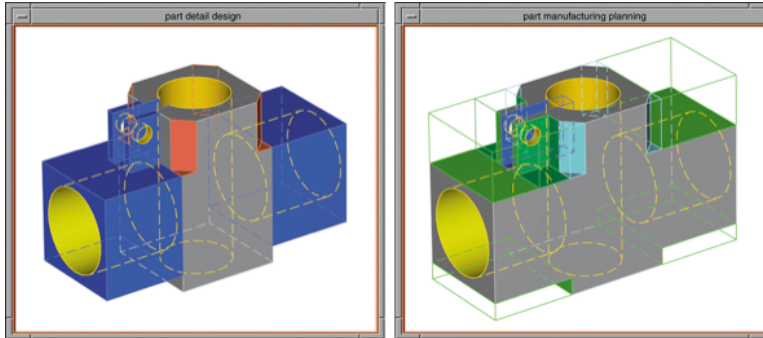

- design and manufacturing views
- feature conversion between views

- **semantic feature modeling:** validity of feature model is maintained during whole modeling process

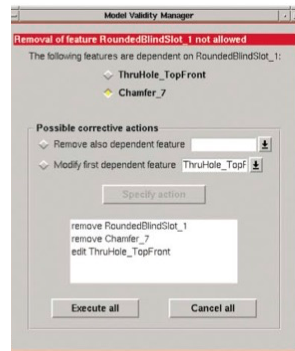
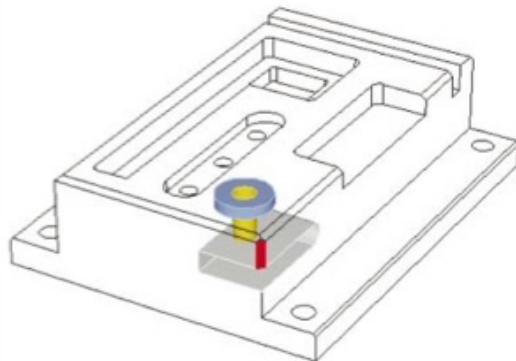

- constraint solving and checking
- cellular models

## Future developments (in my area)

- advanced semantics, at both detail level and global level



detail level: exact semantics  
of complex parts and relations



global level: rough layout and  
contents of virtual worlds

- close integration of models for design and “applications”  
(there is still too much conversion going on)

# Acknowledgements

- the Solid Modeling “Pre-Pioneers”, who inspired me to start working in the area too
- my PhD students, who were willing to listen to my problems and then came up with many good ideas
- the Executive Committees of SMA, who kept the show running
- the Award Committee of SMA, who awarded me the title of Solid Modeling Pioneer

**Thank you all !**